

HALOGEN FREE

REVISIONS			
REV	DESCRIPTION	DWN	DATE
E	Update Drawing	KELLY	2018-09-27
F	Update Date Code	KELLY	2018-10-17

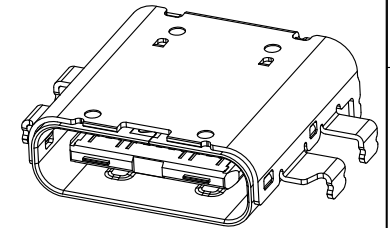

3D VIEW

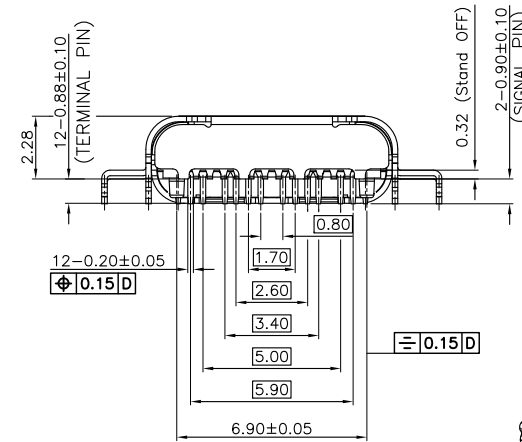
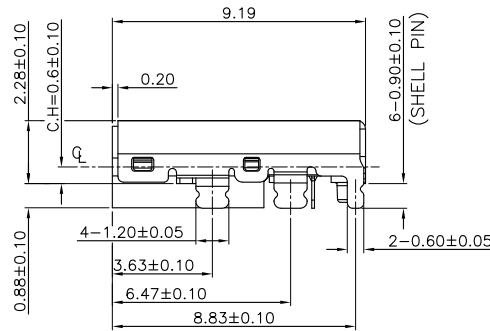
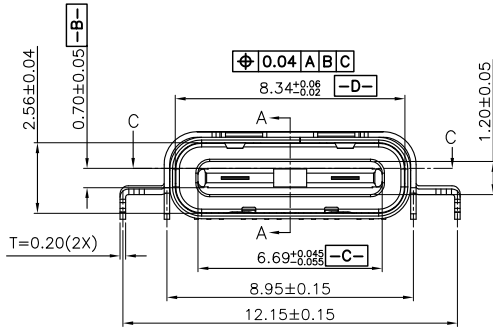
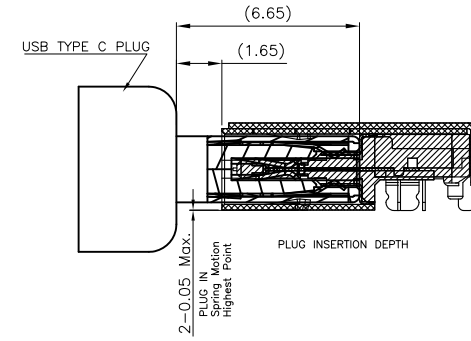
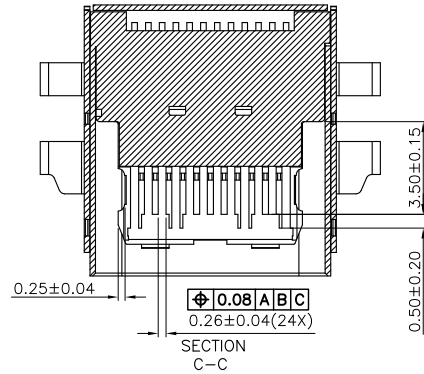
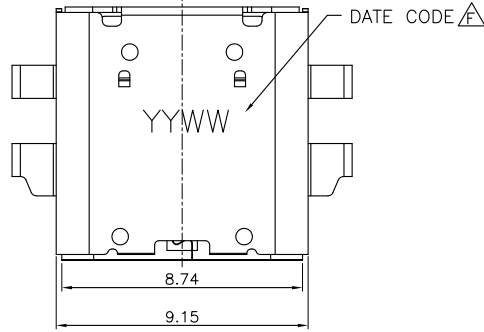
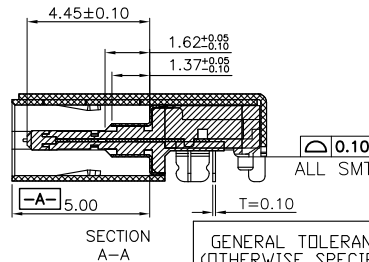
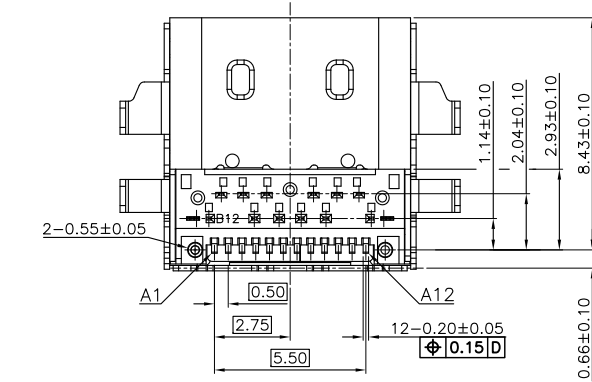

GENERAL TOLERANCES (OTHERWISE SPECIFIED)		SCALE NONE	DESIGN UNITS MILIMETER	VITECK CO., LTD.
4 PLS	\pm	DRAWN BY Kelly Yen	DATE 2018-10-17	
3 PLS	\pm 0.10	CHECKED BY	DATE	PART NO. UTC-007-1R24HX
2 PLS	\pm 0.20	APPROVED BY	DATE	
1 PLS	\pm 0.30	DRAWING NO. SD-UTC007-001		DWG REV. F
ANGLES	\pm °			SHEET NO. 1 OF 2
QUALITY SYMBOLS	∇ = 0			SIZE
THIS DRAWING CONTAINS INFORMATION THAT IS PROPRIETARY TO VITECK CORP., LTD AND SHOULD NOT BE USED WITHOUT WRITTEN PERMISSION				THIRD ANGLE PROJECTION

HALOGEN FREE

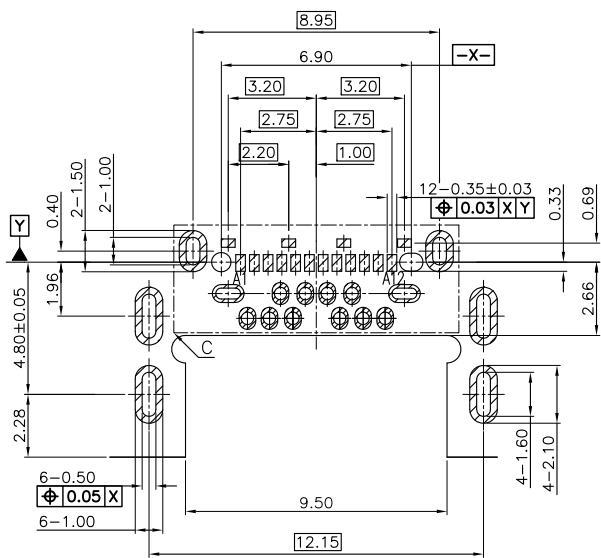

RECOMMENDED PCB LAYOUT(TOP VIEW)
(TOLERANCE=±0.05mm)

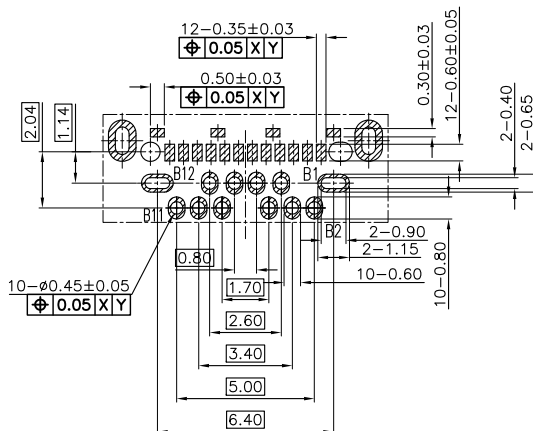

DETAIL C-1

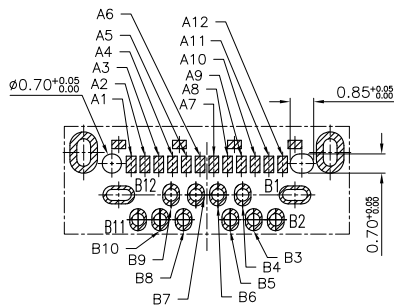

DETAIL C-2

NOTES:

1. MATERIAL:
 - 1.1 OUTSIDE SHELL: SUS301R-1/2H T=0.20mm
 - 1.2 INNER SHELL: SUS301R-1/2H T=0.20mm
 - 1.3 SIGNAL: SUS301R-H T=0.10mm
 - 1.4 RFI PAD: SUS301R-H T=0.08mm
 - 1.5 HOUSING: LCP+30%G.F. UL94UL-0 BLACK
 - 1.6 TEMINARL: C19400-H T=0.10mm
2. PLATING:
 - 2.1 TERMINAL: MATTE Sn 60~150u" ON SOLDERING AREA, 80~150u" NICKEL UNDER PLATING OVERALL
 - 2.2 SHELL: MATTE Sn 50u" Min. ON SOLDERING AREA,NICKEL UNDERPLATED 60u"MIN.
3. ELECTRICAL CHARACTERISTICS:
 - 3.1 CURRENT RATING: 5.0 A
VOLTAGE RATING: 20.0 V
 - 3.2 LLCR: VBUS& GND PINS: 40mΩ/PIN MAX
OTHER PINS : 40mΩ/PIN MAX
CHANGE OF ALL PINS: 10mΩ
 - 3.3 INSULATION RESISTANCE: 100MΩ MIN.
4. MECHANICAL CHARACTERISTICS:
 - 4.1 INSERTION FORCE: 0.5~2.0kg.
 - 4.2 WITHDRAWAL FORCE: 0.8~2.0kg.(INITIAL) 0.6~2.0kg. (AFTER LIFE TEST)
5. LIFE TEST: 10000 CYCLES MIN
6. WELDING OVERLOAD STRENGTH:
7. P/N: UTC-007-1R24HX

PLATING OF CONTACT AREA
G: GOLD FLASH
6: 30u" Au

GENERAL TOLERANCES (OTHERWISE SPECIFIED)		SCALE NONE	DESIGN UNITS MILIMETER	
4 PLS ±		DRAWN BY Kelly Yen	DATE 2018-10-17	
3 PLS ± 0.10		CHECKED BY		USB TYPE C R/A HYBRID TYPE CH=0.60mm H=2.28mm
2 PLS ± 0.20		APPROVED BY		
1 PLS ± 0.30		DATE		
ANGLES ± °		DRAWING NO. SD-UTC007-001		PART NO. UTC-007-1R24HX
QUALITY SYMBOLS ▽=0		THIS DRAWING CONTAINS INFORMATION THAT IS PROPRIETARY TO VITECK CORP., LTD AND SHOULD NOT BE USED WITHOUT WRITTEN PERMISSION		THIRD ANGLE PROJECTION DWG REV. F SHEET NO. 2 OF 2 SIZE

HALOGEN FREE

REVISIONS			
REV	DESCRIPTION	DWN	DATE
A	RFQ-17-048(SAME AS UTC-003)	Kelly Yen	2017-11-23

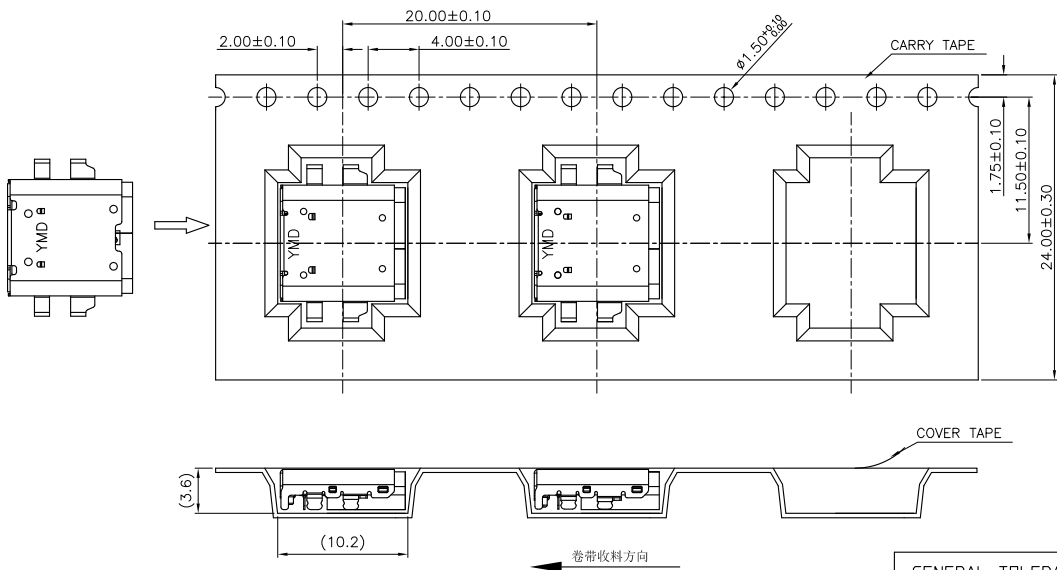
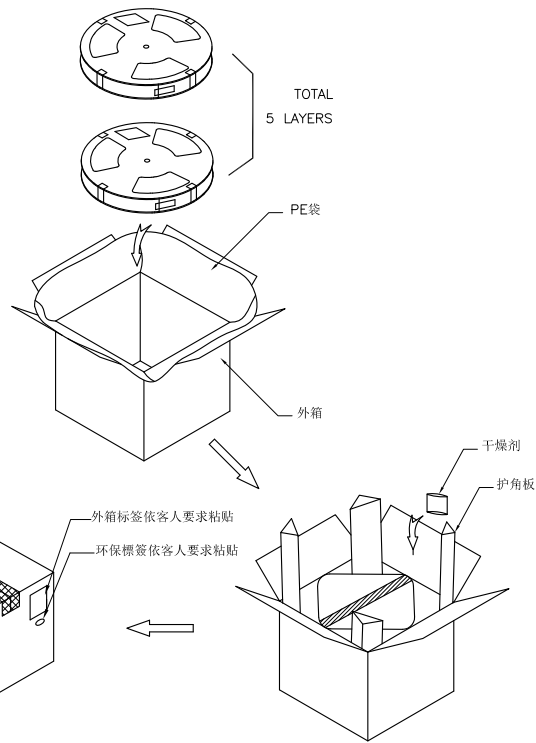
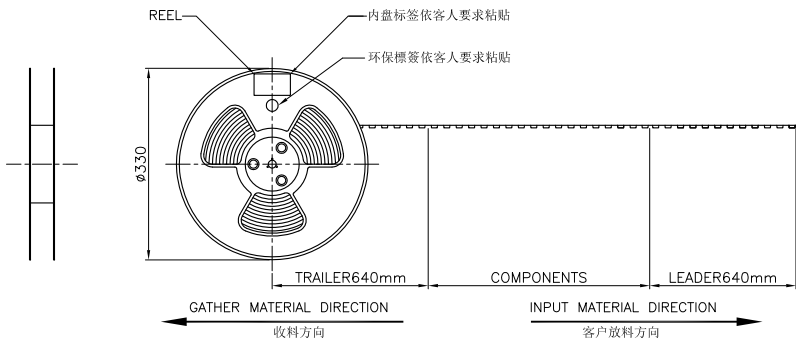

PARTS PER SHIPPING CARTON	PARTS PER REEL (S.P.Q.)	TOTAL REELS PER PRIMARY CARTON
3500 (PCS)	700 (PCS)	5

- Notes:
- 每卷卷带的开始端留30PCS空格不装产品，以实际包装数量装满，结束端预留空出不装产品；
 - 卷带用自封胶带封口，1个卷盘放置700PCS产品；
 - 再绕一个保护带，保护带最后重量约50mm，每个卷盘须贴一张条码标签和无卤标签(或依客人要求粘贴)；
 - 将PE袋套入外箱后，将5盘装好产品的卷盘依次放入纸箱，并在纸箱封角各放入干燥剂一袋；
 - 外箱外侧面以膠帶封口，每個外箱外侧面位置贴一张条码标签和无卤标签(或依客人要求粘贴)；
 - COVER TAPE與CARRY TAPE剝離力：20g~120g；剝離角度：165°~175°；剝離速度：250~300mm/min；
 - 包裝數量：700PCS/REEL，5REEL/CARTON，共3500PCS/CARTON；
 - 此部品必須符合无卤指令要求。

GENERAL TOLERANCES (OTHERWISE SPECIFIED)		SCALE	DESIGN UNITS	
4 PLS ± mm		NONE	MILIMETER	
3 PLS ±		DRAWN BY DATE		TITLE USB TYPE C R/A HYBRID TYPE CH=0.60mm H=2.26mm PACKING
2 PLS ±		Kelly Yen 2017-11-23		
1 PLS ±		CHECKED BY DATE		
ANGLES ± °		APPROVED BY DATE		PART NO. UTC-007-1R24HX
QUALITY SYMBOLS $\nabla \sqrt{C} = 0$		DRAWING NO. PK-UTC007-001		
THIS DRAWING CONTAINS INFORMATION THAT IS PROPRIETARY TO VITECK CORP., LTD AND SHOULD NOT BE USED WITHOUT WRITTEN PERMISSION				THIRD ANGLE PROJECTION
			DWG REV. A	SHEET NO. 1 OF 1

7

6

5

4

3

2

1

E

D

C

B

A

7

6

5

4

3

2

1