

Date Code碼說明, 例如:23103

星期三
第十周
2013年
廠別

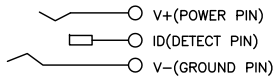

CIRCUIT DIAGRAM

LED TYPE

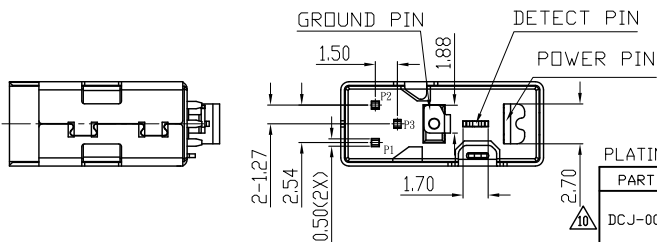
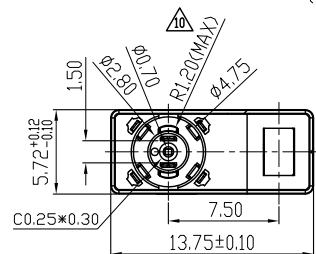
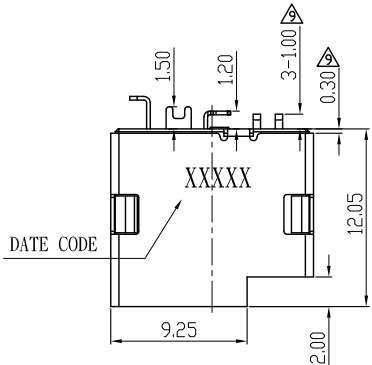
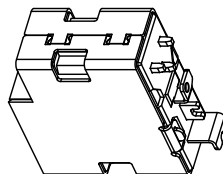
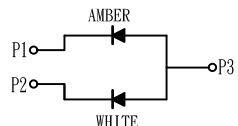

PLATING

| PART No. | DESCRIPTION | PLATING |
|----------------|----------------------------|---|
| DCJ-006-1L06HP | SLIM HP DC JACK-DETECT PIN | 50u"Ni min,Pd/Ni 30u"min with 5u"Au Plating at contact area |
| | SLIM HP DC JACK-POWER PIN | |
| | SLIM HP DC JACK-GROUND PIN | |
| DCJ-006-1L06HI | SLIM HP DC JACK-DETECT PIN | 5u"Au min. on contact area 50u"Ni min underplating. |
| | SLIM HP DC JACK-POWER PIN | |
| | SLIM HP DC JACK-GROUND PIN | |

ELECTRIACL-OPTICAL CHARACTERISTICS.

| Parameter | Symbol | Value | | | Unit | Test condition |
|--------------------|--------|-------|-------|------|-------|----------------|
| | | Min. | Typ. | Max. | | |
| Forward Voltage | Vr | A | 1.7 | 2.0 | 2.8 | V |
| | | W | 2.8 | 3.2 | 3.7 | V |
| Luminous intensity | Iv | A | 37.6 | 130 | 192.4 | mod |
| | | W | 400 | 550 | 1150 | mod |
| | | A | 585 | | 596 | nm |
| Wavelength | λd | X | 0.271 | | | |
| | | Y | 0.245 | | | |
| Reverse Current | Ir | | | 10 | A | |
| Viewing angle | 2θ | | 140 | | Deg | |

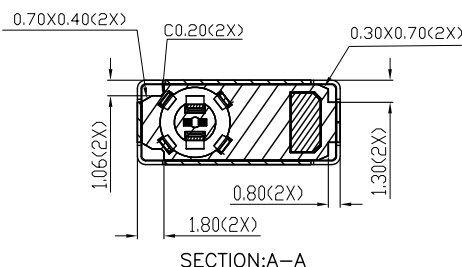
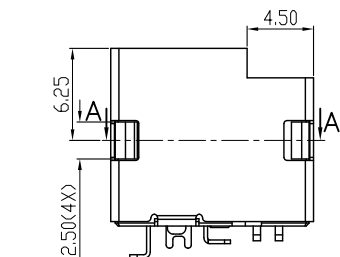

LED'S CHARACTERISTICS:

| NODE | COLOR | DOMINANT WAVELENGTH | FORWARD VOLTAGE | LUMINORS INTENSITY AT 20MA |
|-------|-------|---------------------|-----------------|----------------------------|
| P3(+) | P1(-) | AMBER | 585-596nm | 2.8V MAX 37.6-192.4 MCD |
| P3(+) | P2(-) | WHITE | N/A | 3.7V MAX 400-1150 MCD |

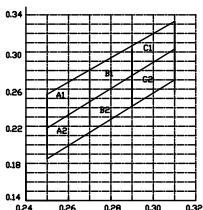

RANG OF BINS(AUQA WHITE)

| Bin | White Min/Max | Amber Min/Max |
|-----|---------------|---------------|
| L | 400-520 | 37.6-192.4 |
| M | 520-680 | 37.6-192.4 |
| N | 680-880 | 37.6-192.4 |
| P | 880-1150 | 37.6-192.4 |

COLOR RANKS.

| A1 | X | 0.27 | 0.27 | 0.25 | 0.25 |
|----|---|------|--------|--------|-------|
| | | Y | 0.2455 | 0.278 | 0.25 |
| A2 | X | 0.27 | 0.27 | 0.25 | 0.25 |
| | | Y | 0.2455 | 0.213 | 0.185 |
| B1 | X | 0.27 | 0.27 | 0.29 | 0.29 |
| | | Y | 0.2455 | 0.278 | 0.306 |
| B2 | X | 0.27 | 0.27 | 0.29 | 0.29 |
| | | Y | 0.2455 | 0.213 | 0.241 |
| C1 | X | 0.29 | 0.31 | 0.31 | 0.29 |
| | | Y | 0.306 | 0.3355 | 0.303 |
| C2 | X | 0.29 | 0.31 | 0.31 | 0.29 |
| | | Y | 0.241 | 0.2705 | 0.303 |

Build of material:

| NO | DESCRIPTION | QTY | MATERIAL | FINISH(OR COLOR) |
|----|----------------------------|-----|-----------------|-------------------|
| 7 | SLIM HP DC JACK-LED | 1 | | AMBER/WHITE |
| 6 | SLIM HP DC JACK-STOPPER | 1 | LCP | BLACK |
| 5 | SLIM HP DC JACK-DETECT PIN | 1 | PHOSPHOR BRONZE | SEE PLATING TABLE |
| 4 | SLIM HP DC JACK-POWER PIN | 1 | PHOSPHOR BRONZE | SEE PLATING TABLE |
| 3 | SLIM HP DC JACK-GROUND PIN | 1 | PHOSPHOR BRONZE | SEE PLATING TABLE |
| 2 | SLIM HP DC JACK-HOUSING | 1 | LCP | BLACK |
| 1 | SLIM HP DC JACK-SHELL | 1 | STAINLESS STEEL | 30u"Ni Min |

| | | | |
|--|---------------------------|------------------------|----------------------------------|
| GENERAL TOLERANCES (OTHERWISE SPECIFIED) | SCALE 1 : 1 | DESIGN UNITS MILIMETER | |
| 4 PLS ± | DRAWN BY ALDO | DATE 2015-09-11 | |
| 3 PLS ± | CHECKED BY | DATE | TITLE SLIM DC JACK WITH 3PIN LED |
| 2 PLS ± 0.20 | APPROVED BY | DATE | PART NO. DCJ-006-1L06HX |
| 1 PLS ± 0.30 | DRAWING NO. SD-DCJ006-001 | | |
| ANGLES ± ° | | | |
| QUALITY SYMBOLS ∇=0 | | | |
| THIS DRAWING CONTAINS INFORMATION THAT IS PROPRIETARY TO VITECK CORP., LTD AND SHOULD NOT BE USED WITHOUT WRITTEN PERMISSION | | | THIRD ANGLE PROJECTION |
| | | DWG REV. 10 | SHEET NO. 1 OF 1 |
| | | | SIZE |

7

6

5

4

3

2

1

REVISIONS

| REV | DESCRIPTION | DWN | DATE |
|-----|-------------|------|------------|
| 2 | PROPOSAL | EDEN | 2015-06-11 |

圖1: 電子盒外觀圖

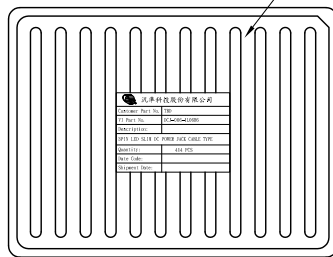

真空盒*19

圖3: 紙箱外觀

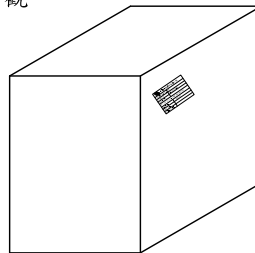

| PRODUCT P/N | PARTS PER SHIPPING CARTON | PARTS PER TRAY | TOTAL TRAYS PER SHIPPING CARTON |
|----------------|---------------------------|----------------|---------------------------------|
| DCJ-006 SERIES | 5382(PCS) | 414(PCS) | 13 |

圖2: 平面圖

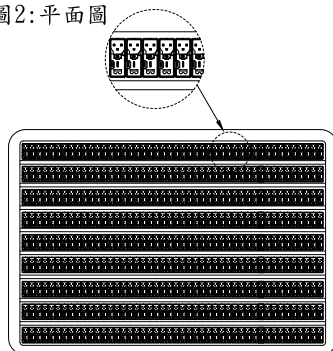

| 材料 | 名稱 | 型號(mm) | 顏色 | 數量 |
|----|-----|---|----|-----|
| 1 | 紙箱 | 12*9 $\frac{1}{4}$ *10 $\frac{1}{4}$ (in) | 土黃 | 1個 |
| 2 | 電子盒 | 290*220mm | 透明 | 13個 |
| 3 | 盒蓋 | 290*220mm | | 13個 |
| 4 | 膠袋 | 600*600mm | 透明 | 1個 |
| 5 | 紙板 | 290*220*4mm | 土黃 | 2個 |
| 6 | 保利龍 | 290*220*10mm | 白色 | 2個 |

打包帶

產品

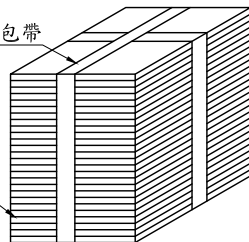

| GENERAL TOLERANCES (OTHERWISE SPECIFIED) | | 1 : 1 | MILIMETER | VITECK CO., LTD. | | | |
|---|--------|--|---------------|-------------------------------------|----------------|---------------------|------|
| 4 PLS | ± mm | DRAWN BY | DATE | TITLE SLIM DC JACK WITH 3PIN LED | | | |
| 3 PLS | ± | EDEN | 2015-06-11 | | | | |
| 2 PLS | ± 0.20 | CHECKED BY | DATE | | | | |
| 1 PLS | ± 0.30 | APPROVED BY | DATE | PART NO. DCJ-006 SERIES | | | |
| ANGLES | ± ° | DRAWING NO. | PK-DCJ006-001 | | | | |
| QUALITY SYMBOLS | | THIS DRAWING CONTAINS INFORMATION THAT IS PROPRIETARY TO VITECK CORP., LTD AND SHOULD NOT BE USED WITHOUT WRITTEN PERMISSION | | THIRD ANGLE PROJECTION | DWG. REV. 2 | SHEET NO. 1 OF 1 | SIZE |

7

6

5

4

3

2

1