

7

6

5

4

3

2

1

REVISIONS

REV	DESCRIPTION	DWN	DATE
G	ADD DIM.	ALDO	2018-05-31

SPECIFICATIONS:

- ELECTRICAL SPEC:
 - RATED CURRENT:4.5A
 - RATED VOLTAGE:20V
 - INSULATION RESISTANCE:100MΩ MIN.AFTER BY 500V DC FOR 1MINUTE
 - DIELECTRIC WITHSTANDING VOLTAGE: 500V AC FOR 1MINUTE
 - CONTACT RESISTANCE:30mΩ MAX(INITIAL)
- MECHANICAL SPEC:
 - INSERTION FORCE:3.0Kgf MAX
 - WITHDRAWAL FORCE:0.4~2.5Kgf MIN AFTER LIFE TEST: 0.5Kgf MIN
- LIFE TEST(INSERTION/WITHDRAWAL):5000 CYCLES MIN
- LOW HALOGEN SPEC:
 - Br < 900 ppm
 - Cl < 900 ppm
 - Br+Cl < 1500 ppm
- MATERIAL:
 - HOUSING:PA4T;UL 94V-0,COLOR:BLACK
 - CONTACT:COPPER ALLOY
 - SHELL:COPPER ALLOY
- FINISH:
 - CONTACT: GOLD PLATING ON CONTACT AREA(SEE NOTE 7),MATTE SN 80u" MIN ON SOLDER TAIL,ALL OVER NI 50u" MIN.
 - SHELL: GOLD PLATING ON CONTACT AREA(SEE NOTE 7), ALL OVER NI 50u" MIN.
- PART LEGEND: DCJ-020-1N03HX

Au PLATING ON CONTACT AREA
 1: 5u" Au
 G: GOLD FLASH
 P: 30u" Pd/Ni MIN WITN 5u" Au

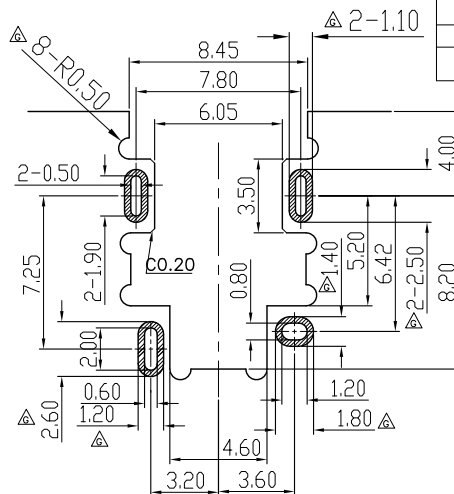

RECOMMENDED PCB LAYOUT TOLERANCE:±0.05mm

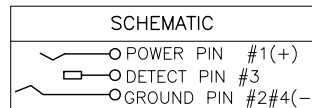
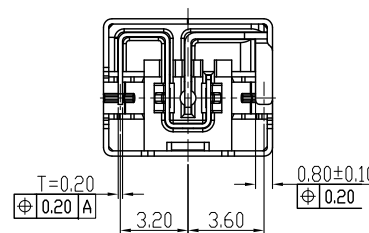

GENERAL TOLERANCES (OTHERWISE SPECIFIED)	SCALE NONE	DESIGN UNITS MILIMETER
4 PLS ±	DRAWN BY JACK WU	DATE 2016-05-10
3 PLS ±	CHECKED BY	DATE
2 PLS ± 0.20	APPROVED BY	DATE
1 PLS ± 0.30	DRAWING NO. SD-DCJ020-001	PART NO. DCJ-020 SERIES
ANGLES ± °		
QUALITY SYMBOLS ∇=0		
THIS DRAWING CONTAINS INFORMATION THAT IS PROPRIETARY TO VITECK CORP., LTD AND SHOULD NOT BE USED WITHOUT WRITTEN PERMISSION		



TITLE
 DC POWER JACK CH=-1.0mm
 H=6.5mm OD=4.6mm

PART NO. DCJ-020 SERIES

THIRD ANGLE PROJECTION	DWG REV. G	SHEET NO. 1 OF 1	SIZE
------------------------	------------	------------------	------

E

D

C

B

A

E

D

C

B

A

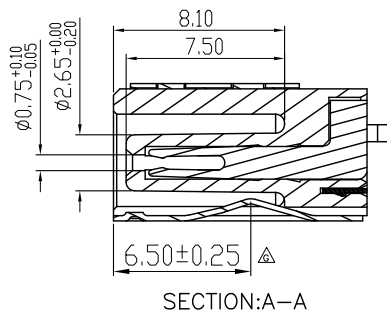
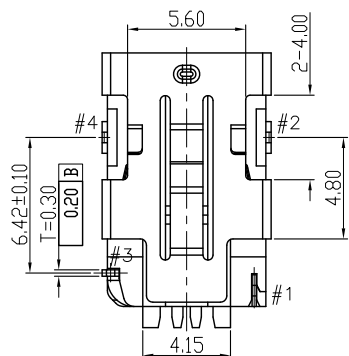
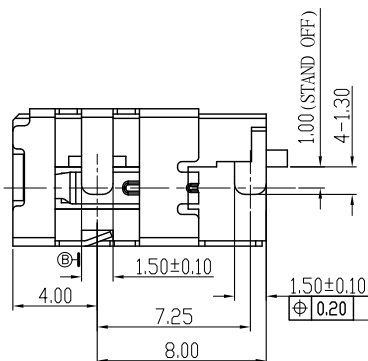
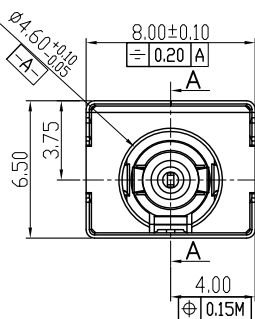
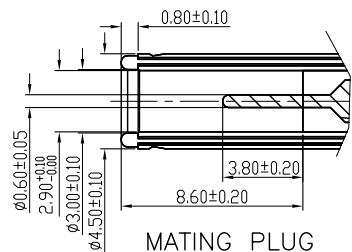
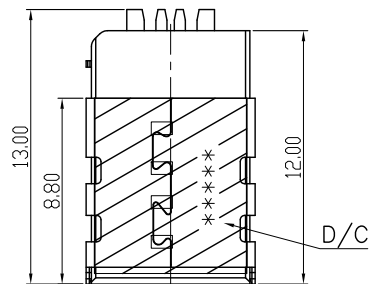

6

5

4

3

2

1

7

6

5

4

3

2

1

REVISIONS			
REV	DESCRIPTION	DWN	DATE
B	CHANGE REEL PITCH	ALDO	2016/12/29

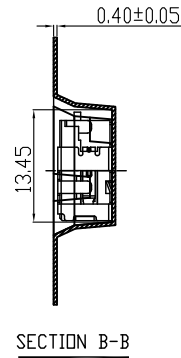
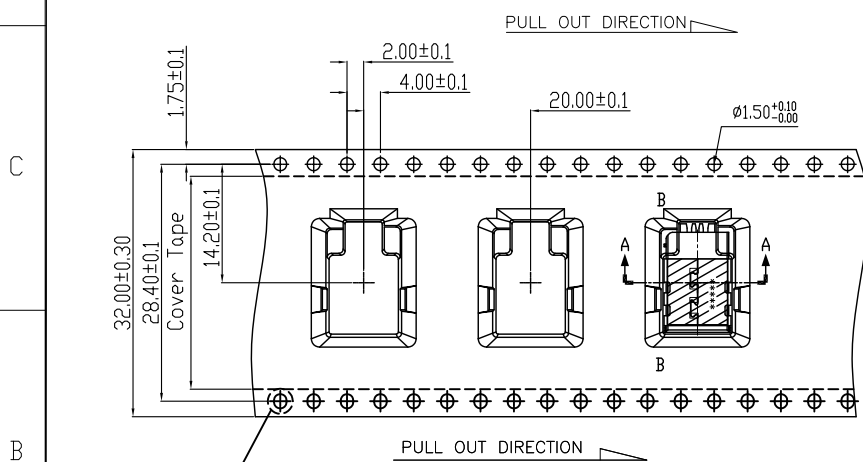
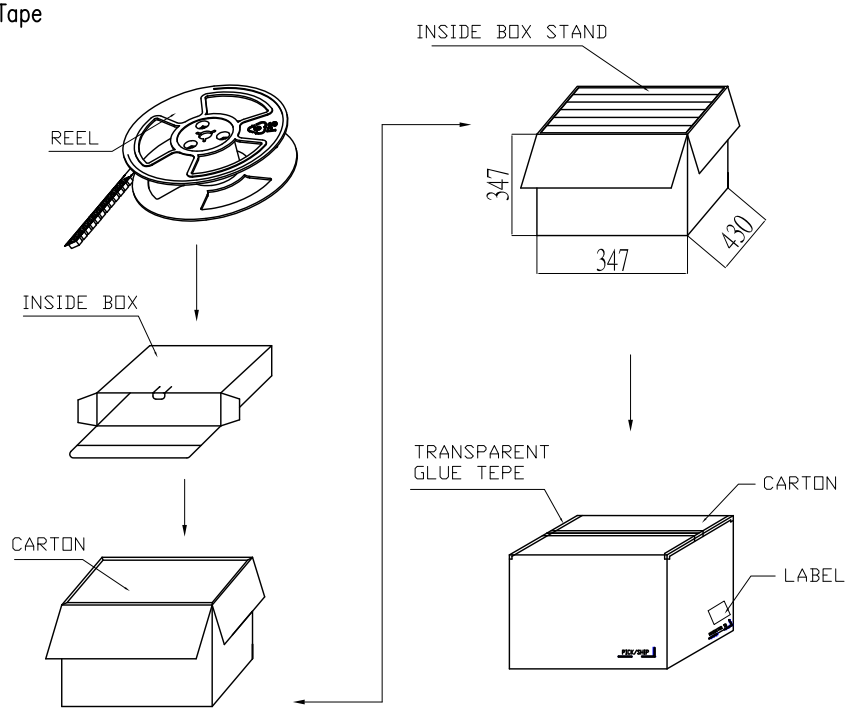
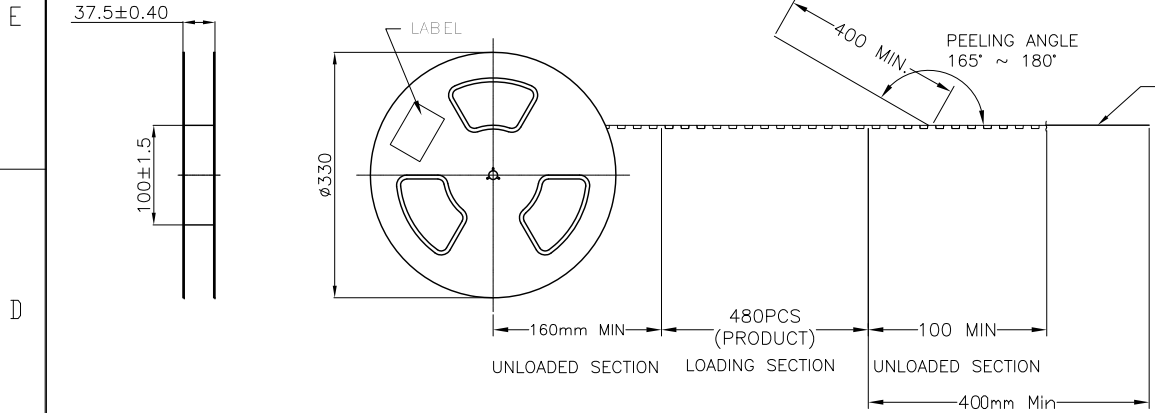

PARTS PER SHIPPING CARTON	PARTS PER REEL (S.P.Q.)	TOTAL REELS PER SHIPPING CARTON
4800(PCS)	480(PCS)	10

GENERAL TOLERANCES (OTHERWISE SPECIFIED)	SCALE	DESIGN UNITS
4 PLS ±	NONE	MILIMETER
3 PLS ±		
2 PLS ± 0.20		
1 PLS ± 0.25		
ANGLES ± °		
QUALITY SYMBOLS		

DRAWN BY	DATE
ALDO	2016-03-29
CHECKED BY	DATE
APPROVED BY	DATE
DRAWING NO.	PK-DCJ020-001

VITECK CO., LTD.			
TITLE			
DC POWER JACK CH=-1.0mm H=6.5mm OD=4.6mm			
PART NO.			
DCJ-020 SERIES			

THIS DRAWING CONTAINS INFORMATION THAT IS PROPRIETARY TO VITECK CORP, LTD AND SHOULD NOT BE USED WITHOUT WRITTEN PERMISSION

THIRD ANGLE PROJECTION	DWG REV.	SHEET NO.	SIZE
	B	1 OF 1	

6

5

4

3

2

1